

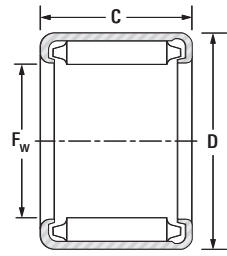

DRAWN CUP NEEDLE ROLLER BEARINGS
FULL COMPLEMENT
OPEN ENDS

METRIC SERIES
BM, BHM, YM SERIES



BM, BHM

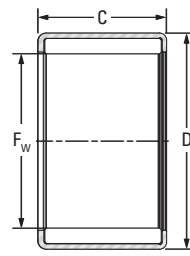

YM

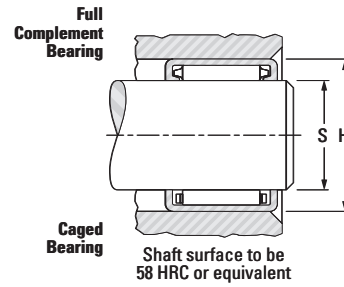

Shaft surface to be 58 HRC or equivalent

Table with columns: Shaft Dia., Fw, D, C, C3 min., Bearing Designation, Load Ratings (Dynamic, Static), Fatigue Load Limit Cu, Approx. Wt., Mounting Dimensions (Shaft, Housing), Inspection gage.

Note) - For information on the speed ratings, contact JTEKT.

CAT.NO.BS007EN-0DS (B-2-38,39) 7

'NEEDLE ROLLER BEARINGS'

The basic dynamic load rating C on these two pages will be corrected as shown in the red frame.

Table with columns: Shaft Dia., Fw, D, C, C3 min., Bearing Designation, Load Ratings (Dynamic, Static), Fatigue Load Limit Cu, Approx. Wt., Mounting Dimensions (Shaft, Housing), Inspection gage. Includes a red frame around the C column values.